

---

# PRODUCT CATALOGUE

Waterproofing Solutions



 **IZOTEX**<sup>®</sup>  
Waterproofing Membranes



# Table of Contents



## Waterproofing Membranes

%100 waterproof, 3-layer, waterproofing membranes used for sealing beneath ceramic. They are used for waterproofing tiled wet areas such as bathrooms, balconies, water tanks and pools.



## Self-Adhesive Waterproofing Membranes

They are the wide-width self-adhesive version of IZOTEX waterproofing membranes. They can be applied simply by peeling and sticking, without the need for any other adhesive.



## Window Sealing Tapes

IZOTEX-WIN is a waterproof, airtight self-adhesive window sealing tape that can be produced in various sizes. It is easily applied as it is self-adhesive to the frame of windows where the joinery will be mounted. It is a specially developed product that can hold plaster.



## WinPro+ Sealing Tape

IZOTEX WINPRO+ is a waterproof, airtight self-adhesive window sealing tape. It is easily applied to window frames.



## Complementary Accessories

Pre-cut and ready to use waterproof sealing tapes that can be produced from all desired Izotex waterproofing membranes. They are manufactured in special widths upon request. Sealing tapes are used to seal overlaps and wall & floor connections in waterproofing applications.

## Waterproofing Membranes

Three - layer sheet waterproofing membranes used under covering materials in wet areas.



# IZOTEX® ULTRA

## Waterproofing Membrane



ULTRA Waterproofing Membrane is made of PES/PE/PES layers, laminated with special fibrous polyester on both sides. This product is 100% waterproof and moisture-resistant, preventing water leaks and moisture damage, especially in wet areas like bathrooms, terraces, roofs, balconies, and pools. Its flexible and bendable structure prevents cracking and ensures excellent flexibility during application. ULTRA provides an ideal surface for ceramic coating after application and offers strong adhesion with all adhesives. Its lightweight and portable design make it easy to apply. The product is packaged in rolls, making it easy to transport and use.

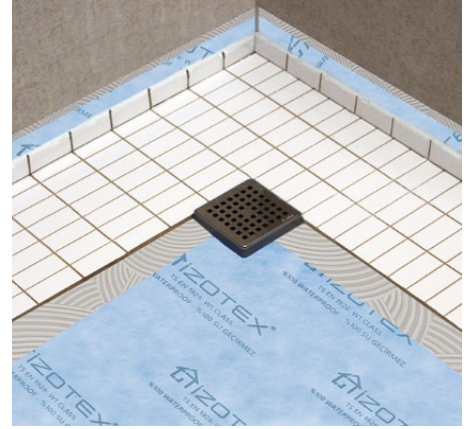

### TECHNICAL DATASHEET

Product Name	IZOTEX ULTRA / Sheet Waterproofing Membrane
Composition	PES / PE / PES
Width of Roll	100 / 50 / 25 cm
Length of Roll	30 m
Color	Blue
Working Temperature	+10 °C / +50 °C
Storage	It can be stored for 12 months in a dry environment between +15 °C / + 25 °C without exposure to sunlight.

PHYSICAL PROPERTIES	TEST METHOD	RESULT	TOLERANS
Weight	EN 1849-2	220 g/m2	+/- 10 g/m2
Standard Roll Length	EN 1848-2	25 m	+/- 1 m
Standard Roll Width	EN 1848-2	100 cm	+/- 1 m
Water Penetration Resistance	TS EN 1928	W1 Class	-
Transversal Resistance to Tearing (Nail Shank)	TS EN 12310-1	120 N	+/- 25 N
Longitudinal Resistance to Tearing (Nail Shank)	TS EN 12310-1	120 N	+/- 25 N
Transversal Tensile Resistance	TS EN 12311-1	220 N	+/- 25 N/5cm
Longitudinal Tensile Resistance	TS EN 12311-1	295 N	+/- 25 N/5cm
Longitudinal Elongation	TS EN 12311-1	%44	+/- 15 %
Elongation at Break	TS EN 12311-1	%93	+/- 15 %
Reaction to Fire	TS EN 11925-2	E Class	-

\*The values above are only for information purpose, cannot be used as an official document.



199537 – DoP –  
2023/08/14 EN 14909

# IZOTEX® MAXI

## Waterproofing Membrane



MAXI Waterproofing Membrane is a three-layer membrane consisting of PP/PE/PP layers. It can be used safely in wet areas such as bathrooms, terraces, flat roofs, water tanks and pools. Its flexible and bendable structure eliminates the risk of cracking and provides long-lasting insulation. The fibrous structure on the surface of the product provides strong adhesion with all adhesives and creates safe connections during application. After application, it creates the ideal surface for coating materials such as ceramics. Its lightweight and portable structure facilitates the transportation and installation process. MAXI, packaged in roll form, offers practical use in the work area.

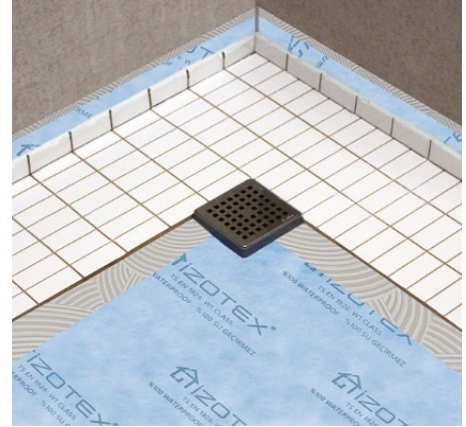

### TECHNICAL DATASHEET

Product Name	IZOTEX MAXI / Sheet Waterproofing Membrane
Composition	PP / PE / PP
Width of Roll	100 / 50 / 25 cm
Length of Roll	30 m
Color	Blue
Working Temperature	+10 °C / +50 °C
Storage	It can be stored for 12 months in a dry environment between +15 °C / + 25 °C without exposure to sunlight.

PHYSICAL PROPERTIES	TEST METHOD	RESULT	TOLERANS
Weight	EN 1849-2	220 g/m <sup>2</sup>	+/- 10 g/m <sup>2</sup>
Standard Roll Length	EN 1848-2	25 m	+/- 1 m
Standard Roll Width	EN 1848-2	100 cm	+/- 1 m
Water Penetration Resistance	TS EN 1928	W1 Class	-
Transversal Resistance to Tearing (Nail Shank)	TS EN 12310-1	80 N	+/- 15 N
Longitudinal Resistance to Tearing (Nail Shank)	TS EN 12310-1	85 N	+/- 15 N
Transversal Tensile Resistance	TS EN 12311-1	480 N	+/- 40 N/5cm
Longitudinal Tensile Resistance	TS EN 12311-1	510 N	+/- 40 N/5cm
Longitudinal Elongation	TS EN 12311-1	%51	+/- 15 %
Elongation at Break	TS EN 12311-1	%55	+/- 15 %
Reaction to Fire	TS EN 11925-2	E Class	-

\*The values above are only for information purpose, cannot be used as an official document.



199537 – DoP –  
2023/08/14 EN 14909

# IZOTEX® EXTRA

## Waterproofing Membrane



EXTRA Waterproofing membrane consisting of PP/PU/PP layers and designed especially for waterproofing of large areas. It is used safely in wet areas such as flat roofs, terraces and bathrooms thanks to its 100% waterproof and moisture balancing feature.

Its 150 cm wide design provides ease of application on large surfaces. The special fibrous structure provides strong adhesion with adhesives. Once applied, the surface is ready for tiling or other floor coverings. With its light and easy-to-carry design, EXTRA provides maximum efficiency and convenience for professionals.

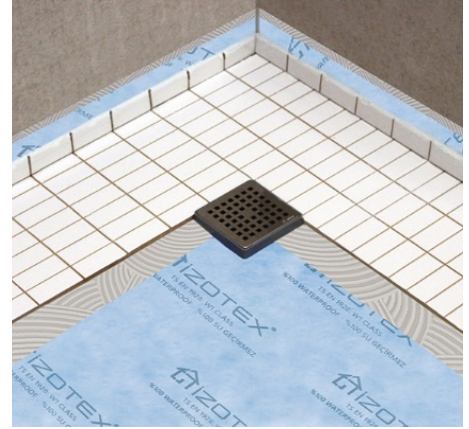

### TECHNICAL DATASHEET

Product Name	IZOTEX EXTRA / Sheet Waterproofing Membrane
Composition	PP / PU / PP
Width of Roll	150 / 50 / 25 cm
Length of Roll	30 m
Color	Blue
Working Temperature	+10 °C / +50 °C
Storage	It can be stored for 12 months in a dry environment between +15 °C / + 25 °C without exposure to sunlight.

PHYSICAL PROPERTIES	TEST METHOD	RESULT	TOLERANS
Weight	EN 1849-2	200 g/m <sup>2</sup>	+/- 10 g/m <sup>2</sup>
Standard Roll Length	EN 1848-2	30 m	+/- 1 m
Standard Roll Width	EN 1848-2	150 cm	+/- 1 m
Water Penetration Resistance	TS EN 1928	W1 Class	-
Transversal Resistance to Tearing (Nail Shank)	TS EN 12310-1	315 N	+/- 25 N
Longitudinal Resistance to Tearing (Nail Shank)	TS EN 12310-1	235 N	+/- 25 N
Transversal Tensile Resistance	TS EN 12311-1	600 N	+/- 60 N/5cm
Longitudinal Tensile Resistance	TS EN 12311-1	720 N	+/- 60 N/5cm
Longitudinal Elongation	TS EN 12311-1	%49	+/- 15 %
Elongation at Break	TS EN 12311-1	%53	+/- 15 %
Reaction to Fire	TS EN 11925-2	E Class	-

\*The values above are only for information purpose, cannot be used as an official document.



## Application Instructions of IZOTEX Membranres



### 1- SURFACE PREPARATION

The surface must be clean, dry and free of granular substances to achieve optimal bonding. Clean the work area until the surfaces are completely grease-free and dry.



### 2- INSTALLATION OF SHOWER CHANNEL

Shower drain is placed to the drain hole.

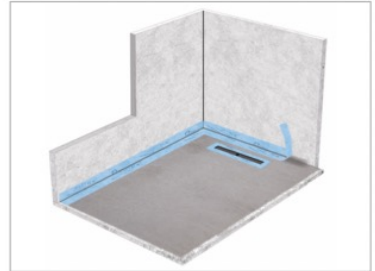

### 3- SEALING OF HORIZONTAL WALL & FLOOR CONNECTIONS

The horizontal wall & floor connections are sealed with IZOTEX Self-Adhesive Waterproof Sealing Tape. The tape is bonded after the protective paper is removed. Air voids are removed by applying pressure to ensure better sealing.

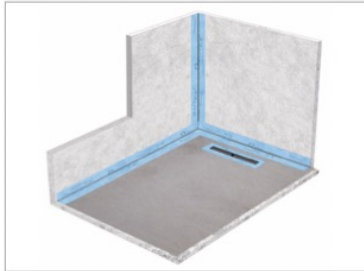

### 4- SEALING OF VERTICAL WALL CONNECTIONS

The vertical wall connections are sealed with IZOTEX Waterproof Sealing Tape starting from top to the bottom. The sealing tape is lapped over previously applied horizontal seals to secure corners. The tape is bonded after the protective paper is removed. Air voids are removed by applying pressure to ensure better sealing.

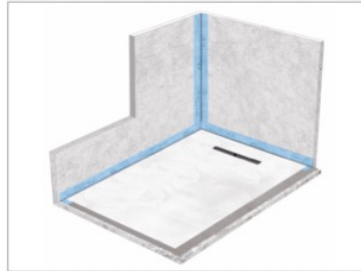

### 5- APPLICATION OF ADHESIVE TO THE FLOOR

Thin set mortar is applied to the floor surface with notched trowel.

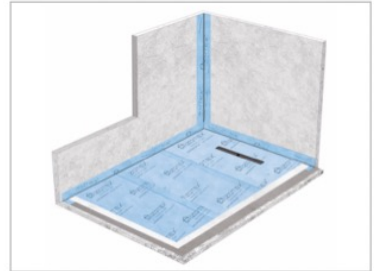

### 6- APPLICATION OF THE MEMBRANE ON FLOOR

The membrane is laid to the floor according to water flow direction. It is bonded to surface before adhesive gets dry. To ensure better adhesion, air voids should be removed by applying pressure. There should be 10 cm overlaps at joints which are adhered with class C2 adhesive. It is recommended to use IZOTEX Self-Adhesive Sealing Tape above overlaps for safer sealing.

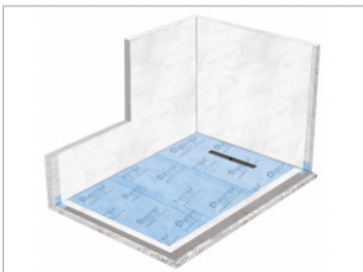

### 7- APPLICATION OF ADHESIVE TO THE WALLS

Thin set mortar is applied to the wall surface with notched trowel.



### 8- APPLICATION OF THE MEMBRANE ON WALLS

The membrane is applied on walls starting from top to bottom. For better sealing, air voids should be removed by applying pressure. There should be 10 cm overlap at joints which are bonded with class C2 tile adhesive. It is recommended to use IZOTEX Self-Adhesive Sealing Tape above overlaps for safer sealing.

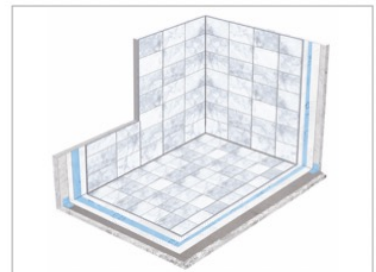

### 9- TILING

IZOTEX Membrane can be directly tiled.



# Self Adhesive Waterproofing Membranes

Self Adhered waterproofing membranes, provide waterproofing at wet areas



# IZOTEX® PLUS+

## Self Adhesive Waterproofing Membrane

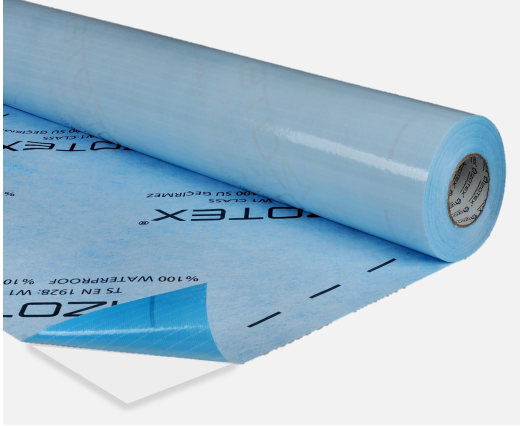

PLUS+ Waterproofing Membrane is a self-adhesive, 100% waterproof membrane made from PP/PU/PP/A/P layers. It can be easily applied by simply removing the protective backing, eliminating the need for additional adhesives. The membrane can be applied directly to surfaces and adheres easily to both vertical and horizontal surfaces, providing effective waterproofing. Its flexible and bendable structure prevents cracking and ensures reliable performance. Once applied, it creates an optimal surface for ceramic tiling. EXTRA PLUS+ is lightweight and easy to handle, offering savings in time, labor, and cost, making it a practical solution for waterproofing.

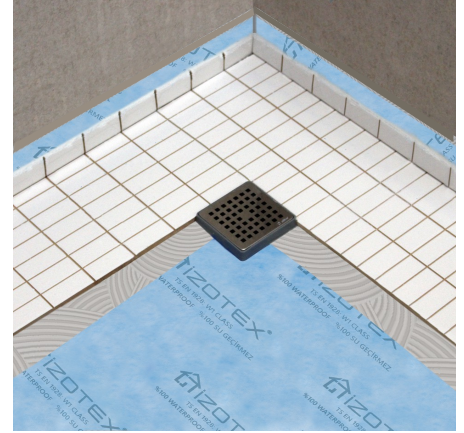

### TECHNICAL DATASHEET

Product Name	IZOTEX PLUS / Self-Adhesive Waterproofing Membrane
Composition	PES / PE / A / P
Width of Roll	100 / 50 / 25 cm
Length of Roll	30 m
Color	Blue
Working Temperature	+10 °C / +50 °C
Storage	It can be stored for 12 months in a dry environment between +15 °C / + 25 °C without exposure to sunlight.

PHYSICAL PROPERTIES	TEST METHOD	RESULT	TOLERANS
Weight	EN 1849-2	370 gsm	+/- 10 g/m2
Standard Roll Width	EN 1848-2	100 cm	+/- 1 m
Standard Roll Length	EN 1848-2	30 m	+/- 1 m
Water Penetration Resistance	TS EN 1928	W1	-
Transversal Resistance to Tearing (Nail Shank)	TS EN 12310-1		+/- 15 N
Longitudinal Resistance to Tearing (Nail Shank)	TS EN 12310-1		+/- 15 N
Transversal Tensile Resistance	TS EN 12311-1		+/- 45 N/5cm
Longitudinal Tensile Resistance	TS EN 12311-1		+/- 35 N/5cm
Longitudinal Elongation	TS EN 12311-1		+/- 6 %
Elongation at Break	TS EN 12311-1		+/- 8 %
Reaction to Fire	TS EN 11925-2	Class E	-

\*The values above are only for information purpose, cannot be used as a official document.



199537 – DoP –  
2023/08/14 EN 14909

## Application Instructions of Self-Adhesive Membranes



### 1- SURFACE PREPARATION

The surface must be clean, dry and free of granular substances to achieve optimal bonding. Clean the work area until the surfaces are completely grease-free and dry.



### 2- INSTALLATION OF SHOWER CHANNEL

Shower drain is placed to the drain hole.

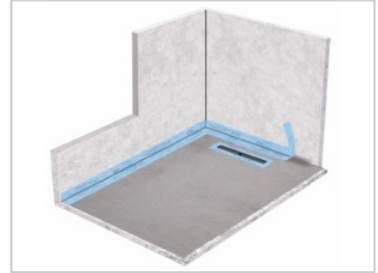

### 3- SEALING OF HORIZONTAL WALL & FLOOR CONNECTIONS

The horizontal wall & floor connections are sealed with IZOTEX Waterproof Sealing Tape. The protective paper is removed, and the tape is bonded by applying pressure. Air voids should be removed to ensure better sealing.

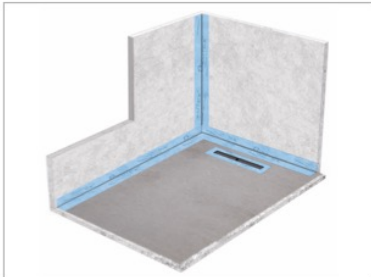

### 4- SEALING OF VERTICAL WALL CONNECTIONS

The vertical wall connections are sealed with IZOTEX Waterproof Sealing Tape starting from top to the bottom. The sealing tape is lapped over previously applied horizontal seals to secure corners. The tape is bonded after the protective paper is removed. Air voids are removed by applying pressure to ensure better sealing.

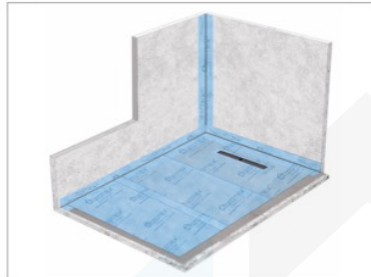

### 5- APPLICATION OF THE MEMBRANE ON FLOORS

The membrane is laid and bonded to the floor according to water flow direction. It is suggested to start application from edges. There should be 10 cm overlap at joints.

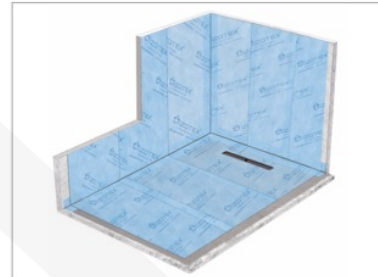

### 6- APPLICATION OF THE MEMBRANE ON WALLS

IZOTEX MAXI 200 PLUS Self-Adhesive Membrane is applied to the wall starting from top to bottom. It overlaps with corner sealing tape and air pockets are removed by applying pressure.

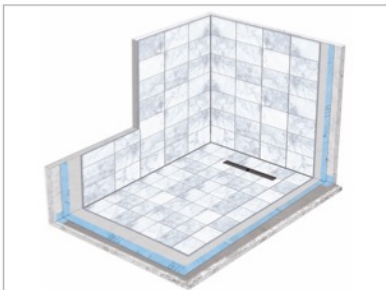

### 7- TILING

After IZOTEX Self-Adhesive Membrane Application is finished, it can be directly tiled.

# Self Adhesive Window Sealing Tapes

Pre-assembled Window Sealing Tapes and provide airtightness and watertightness at window installation.





Self Adhesive  
Windows Sealing Tape



Self-Adhesive  
Windows Sealing Tape

IZOTEX Win is a full surface self-adhesive window sealing tape used for sealing of window and masonry connections/joints. It is a driving rain resistant and windtight tape specially designed for window sealing. Thanks to its variable Sd smart membrane structure, IZOTEX Win prevents the passage of water and wind while allowing water vapour diffusion. The adhesive of IZOTEX Win has been specially developed to bond instantly and strongly to the frame and masonry without requiring additional adhesive or primer. The full surface back adhesive is covered with strip protective liner that makes it easy to peel and apply. The special fibrous top layer is designed for plastering and painting over.

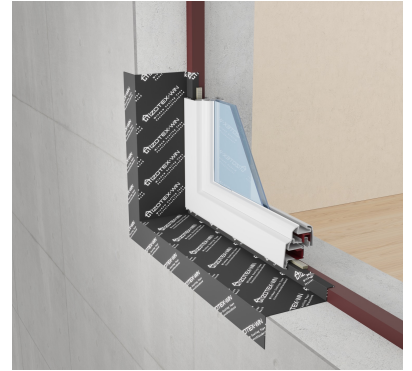

TECHNICAL DATASHEET

Product Name	IZOTEX WIN / Self Adhesive Window Sealing Tape		
Composition	PES / PE / A / P		
Width of Roll	30 / 25 / 20 cm		
Length of Roll	25 m		
Color	Black		
Working Temperature	+10 °C / +50 °C		
Storage	It can be stored for 12 months in a dry environment between +15 °C / + 25 °C without exposure to sunlight.		

PHYSICAL PROPERTIES	TEST METHOD	RESULT	TOLERANS
Weight	EN 1849-2	315 g/m2	+/- 40 g/m2
Standard Roll Width	EN 1848-2	25 cm	+/- 1 cm
Standard Roll Length	EN 1848-2	25 m	+/- 1 m
Water Penetration Resistance	TS EN 1928	W1 Class	-
Transversal Resistance to Tearing (Nail Shank)	TS EN 12310-1	215 N	+/- 15 N
Longitudinal Resistance to Tearing (Nail Shank)	TS EN 12310-1	155 N	+/- 15 N
Transversal Tensile Resistance	TS EN 12311-1	535 N	+/- 45 N/5cm
Longitudinal Tensile Resistance	TS EN 12311-1	555 N	+/- 35 N/5cm
Longitudinal Elongation	TS EN 12311-1	%63	+/- 9 %
Elongation at Break	TS EN 12311-1	%65	+/- 9 %
Reaction to Fire	TS EN 11925-2	E Class	-

\*The values above are only for information purpose, cannot be used as a official document.



Self-Adhesive



Custom Width  
Size



Waterproof



Airtight



Breathable



199537 – DoP –  
2023/08/14 EN 14909

# IZOTEX® PROWIN+

Self Adhesive  
Windows Sealing Tape



Self-Adhesive  
Windows Sealing Tape

IZOTEX Win is a full surface self-adhesive IZOTEX WIN PRO+ is a window sealing tape designed for projects where metal windows frames are not used. It adheres directly to the window frame and wall. The special adhesive on both sides perfectly seals the gaps between the window frame and the wall, preventing water and air infiltration. This helps prevent cold air from entering the interior during winter and hot air from entering during summer, thereby improving energy efficiency. IZOTEX WIN PRO+ also offers an easy-to-install solution as it does not require additional primer or adhesive. Its fibrous top layer ensures perfect compatibility with plaster and adhesive mortars, allowing it to be directly plastered over.

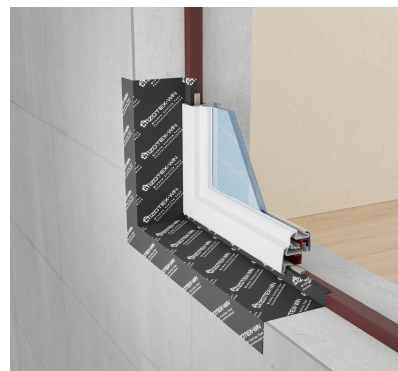

## TECHNICAL DATASHEET

Product Name	IZOTEX WINPRO+ / Self Adhesive Window Sealing Tape
Composition	PES / PE / A / P
Width of Roll	30 / 25 / 20 cm
Length of Roll	25 m
Color	Black
Working Temperature	+10 °C / +50 °C
Storage	It can be stored for 12 months in a dry environment between +15 °C / + 25 °C without exposure to sunlight.

PHYSICAL PROPERTIES	TEST METHOD	RESULT	TOLERANS
Weight	EN 1849-2	315 g/m2	+/- 40 g/m2
Standard Roll Width	EN 1848-2	25 cm	+/- 1 cm
Standard Roll Length	EN 1848-2	25 m	+/- 1 m
Water Penetration Resistance	TS EN 1928	W1 Class	-
Transversal Resistance to Tearing (Nail Shank)	TS EN 12310-1	215 N	+/- 15 N
Longitudinal Resistance to Tearing (Nail Shank)	TS EN 12310-1	155 N	+/- 15 N
Transversal Tensile Resistance	TS EN 12311-1	535 N	+/- 45 N/5cm
Longitudinal Tensile Resistance	TS EN 12311-1	555 N	+/- 35 N/5cm
Longitudinal Elongation	TS EN 12311-1	%63	+/- 9 %
Elongation at Break	TS EN 12311-1	%65	+/- 9 %
Reaction to Fire	TS EN 11925-2	E Class	-

\*The values above are only for information purpose, cannot be used as a official document.



Self-Adhesive



Custom Width  
Size



Waterproof



Airtight



Breathable



199537 – DoP –  
2023/08/14 EN 14909

## Joint Sealing Tapes

Customised width, %100 waterproof, sealing tapes used to seal overlaps, wall & floor connections and joints. Sealing tapes are applied using adhesive, while self-adhesive sealing tapes are applied by peeling and sticking.



### Sealing Tapes

Pre-cut and ready to use waterproof sealing tapes that can be produced from all desired waterproofing membrane. They are manufactured in special widths upon request. Sealing tapes are used to seal overlaps and wall & floor connections in waterproofing applications.



### Self-Adhesive Sealing Tapes

Pre-cut, ready to use self-adhesive waterproof sealing tapes made of Izotex Self-adhesive membranes. They are manufactured in special widths upon request. The specially formulated adhesive on the back provides strong adhesion to many surfaces. The fibrous front surface creates an ideal surface for tiling.

## Sealing Cuff for Shower Drains

Pre-assembled sealing membranes and provide %100 watertightness at shower drains.

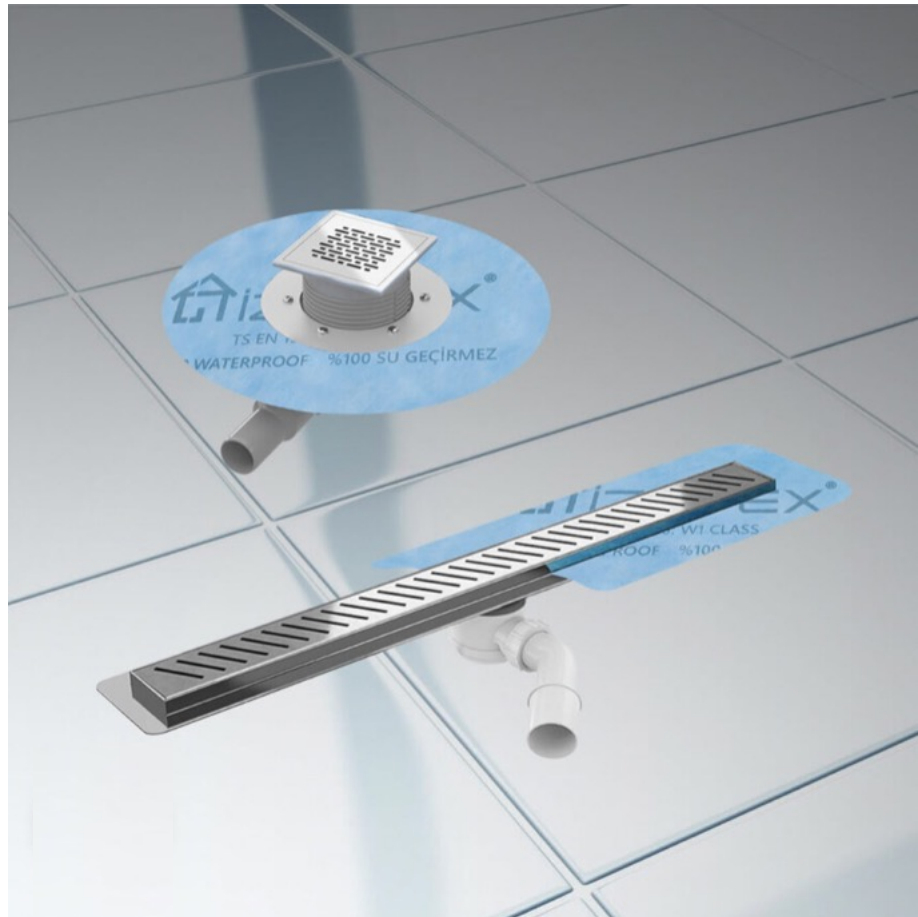



Pre-assembled sealing membranes and provide watertightness at shower drains. IZOTEX Sealing Cuffs ensure waterproofing by acting as a sealing sleeve at shower drains. It is specially designed for the manufacturing of waterproof ready-to-use shower drains.

Both sealing membranes and self-adhesive waterproofing membranes are used as a sealing cuffs. We are able to produce private label for drain manufacturers with their own designs and prints.

It is intended for sealing the penetrations around the drains. With combination IZOTEX waterproofing membranes , makes further processing simple

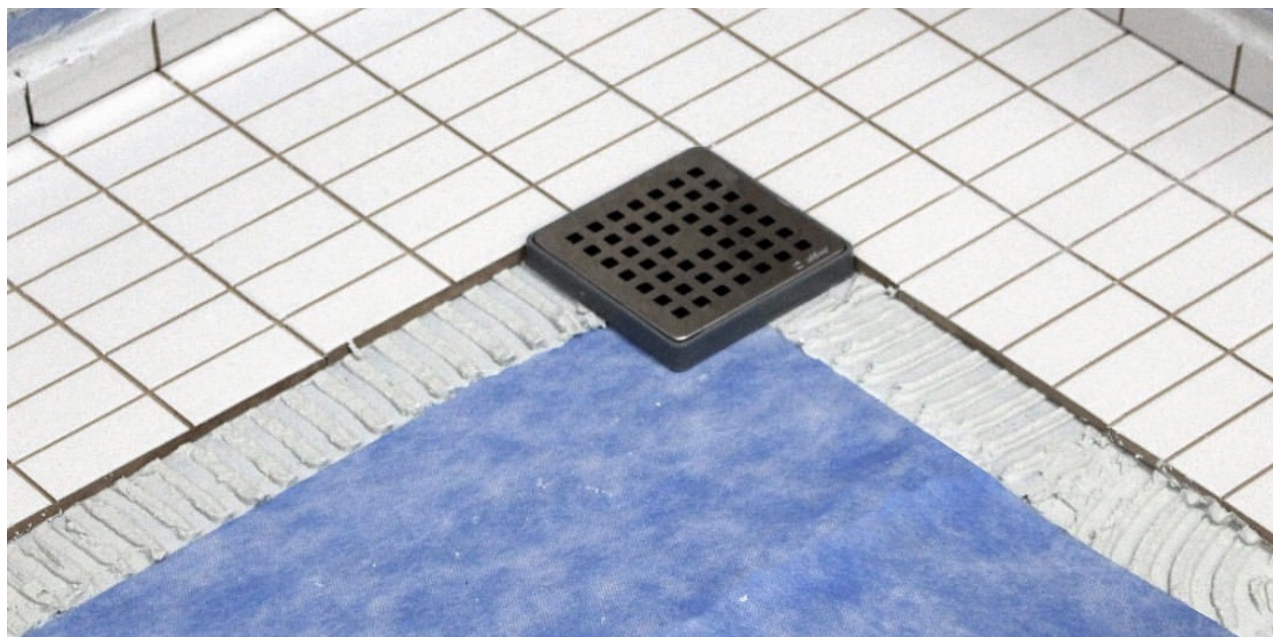



Waterproofing Membranes

23 Nisan Cd. No:2 34520  
Beylikduzu / Istanbul / TURKEY

+90 212 886 83 70

info@izotex.com

www.izotex.com